

a Termoli

Confidential Negotiation

Ref. F718



1.000 sq.m

1,000 sq m warehouse plus offices for rent in Termoli's industrial area.

If you're looking for a large, versatile space in a truly prime location, this warehouse in the Termoli Industrial Zone is perfect for you.

The 1,000 sq m building is barrier-free, facilitating loading and unloading operations. The structure has two entrances for easy accessibility and improved workflow management.

100m² offices on the first floor and a large maneuvering area.

Why choose this particular shed?

I'll tell you right away:

BUSINESS LOCATION: Located in the heart of Termoli's manufacturing district. Ideal for logistics, production, a warehouse, or a workshop, with excellent road connections and the convenience of having services and other businesses just steps away.

READY-TO-USE SPACE: A generous space on two levels (ground floor and first floor) that gives you the flexibility you need. You can organize production on the ground floor and offices or a showroom on the first floor. The structure is solid and functional.

ABSOLUTE VERSATILITY: Whether you work in mechanical engineering, distribution, or warehousing, or have an innovative business project, these spaces can adapt to your needs. We can discuss customization options with you.

Imagine moving your business here already!

Imagine the convenience of having everything at your fingertips, optimizing delivery times, and growing your business in a professional, well-served environment.

Don't let this opportunity pass by to another entrepreneur like you.

Call me now at Raul 3294363448 to schedule a visit immediately!
Come see the potential of this space for yourself. I'll be happy to help you find the best rental solution for you.
Contact me without obligation for any information.

Property Informations

: 86039

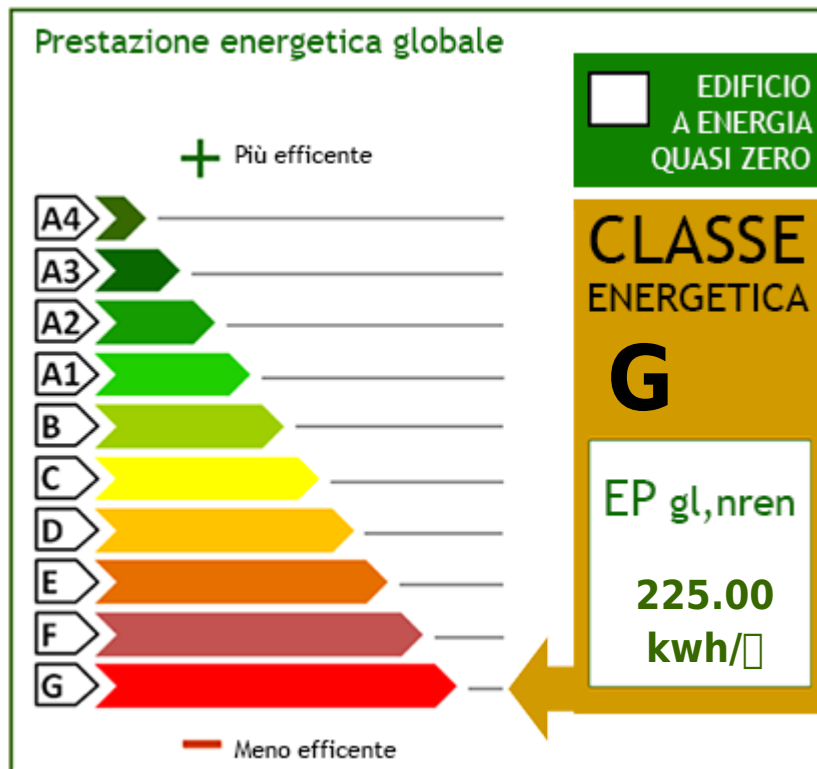



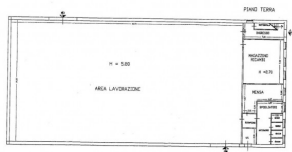

PIANO TERRA
SCALA 1: 200